

OFFICER DELEGATION SCHEME RECORD OF OPERATIONAL DECISION



TO BE UPLOADED TO THE E-MEETINGS MANAGER

Date: 24.06.19	Ref No: 3343	
Type of Operational Decision:		
Executive Decision	<input checked="" type="checkbox"/>	Council Decision
Status: For publication		
Title/Subject matter: Park Lane and Pinfold Lane, Whitefield – Temporary Closures		
Budget/Strategy/Policy/Compliance – Is the decision:		
(i) within an Approved Budget	✓	
(ii) not in conflict with Council Policy	✓	
(iii) not raising new issues of Policy	✓	
Equality Analysis [Does this decision change or make policy; change or make procedure or working practice? An Equality Analysis must be completed to assess the impact on equality and the relevance of the Public Sector Equality Duty. This should be signed off by your departmental equality representative and accompany this decision form. Please forward a copy to the Equality email for publication].	No	
	Signed: (By EA Officer)	Date:
Details of Operational Decision Taken [with reasons]: Approval to the temporary closure under Section 14(1) of the Road Traffic Regulation Act 1984, of Park Lane, Whitefield (southerly side footway) from it junction with Higher Lane for a distance of 90 metres in a westerly direction from Monday 29 June 2019 for a period of 3 months to facilitate traffic signal ducting works (anticipated duration one week). Diversion will be via Park Lane, northerly side footway. Also approval to the temporary closure under Section 14(1) of the Road Traffic Regulation Act 1984, of Pinfold Lane, Whitefield. Carriageway from its junction with Higher Lane for a distance of 60 metres in an easterly direction for a period of 3 months to facilitate traffic signal ducting works (anticipated duration 1 week). Diversion will be via Higher Lane, Church Lane and Bury New Road and vice-versa.		
Decision taken by:	Signature:	Date:
D R Giblin Head of Engineering		09/07/19
Members Consulted [see note 1 below]		
Cabinet Member/Chair		
Lead Member		
Opposition Spokesperson		

Notes

1. It is not generally a requirement to consult with any Members on Operational Decisions but where an Executive Director considers it necessary to consult with the appropriate Cabinet Member and/or Lead Member, they must sign the form so as to confirm that they have been consulted and that they agree with the proposed action. The signature of the Opposition Spokesperson should be obtained to confirm that he/she has been consulted.
2. **This form must not be used for urgent decisions.**











January 2015

BURY COUNCIL
PROPOSED TEMPORARY TRAFFIC CONTROL BY NOTICE
ROAD TRAFFIC REGULATION ACT 1984 SECTION 14(1)

Name and Lengths of Road(s) Affected	1) Park Lane, Whitefield – southerly side footway from its junction with Higher Lane for a distance of 90 metres in a westerly direction 2) Pinfold Lane, Whitefield – carriageway from its junction with Higher Lane for a distance of 60 metres in an easterly direction		
Reason for Notice/Order	To facilitate traffic signal ducting works.		
Nature of Notice/Order	Temporary closure		
Period of Notice/Order	3 months		
Date of Commencement of Notice/Order	Monday 29 July 2019		
Anticipated Duration of Works	1) 1 week (29.07.19 to 05.08.19) 2) 1 week (12.08.19 to 19.08.19)		
Is the Emergency Procedure being invoked?	YES/NO Note: For an unforeseen crisis a road may be closed for up to 21 days		
Is a Temporary Order to be made?	YES/NO		
Description of Alternative Route(s)	1) Via Park Lane northerly side footway. 2) Via Higher Lane, Church Lane and Bury New Road and vice-versa		
Have Notices been Posted?	YES/NO		
Name of Person to be Contacted for Further Information.	Joe Goldstone Tel: 0161-253-5830		
Emergency Closures - Have the following been informed?	Police	YES/NO	NOT APPLICABLE
	Fire	YES/NO	
	Ambulance	YES/NO	
	TfGM	YES/NO	
	Streetworks	YES/NO	
Recharge Code	465 HAM4000 5641 H		

Head of Engineering 
 Delegated Powers Form Ref No 3343

Date 25/06/19

QTY: 2 Pedestrians Use Other Footway	
QTY: 2 Nature of temporary hazard ahead - Footpath Closed	
QTY: 8 Road works ahead	
QTY: 2 Direction to hazard (variant)	
QTY: 2 Direction to hazard	
QTY: 4 End plate	
QTY: 3 Road narrows on one side only ahead	
QTY: 1 Road narrows on one side only ahead (variant)	
QTY: 1 Keep left	
QTY: 2 Keep right	
QTY: 1 Lane closure barrier	

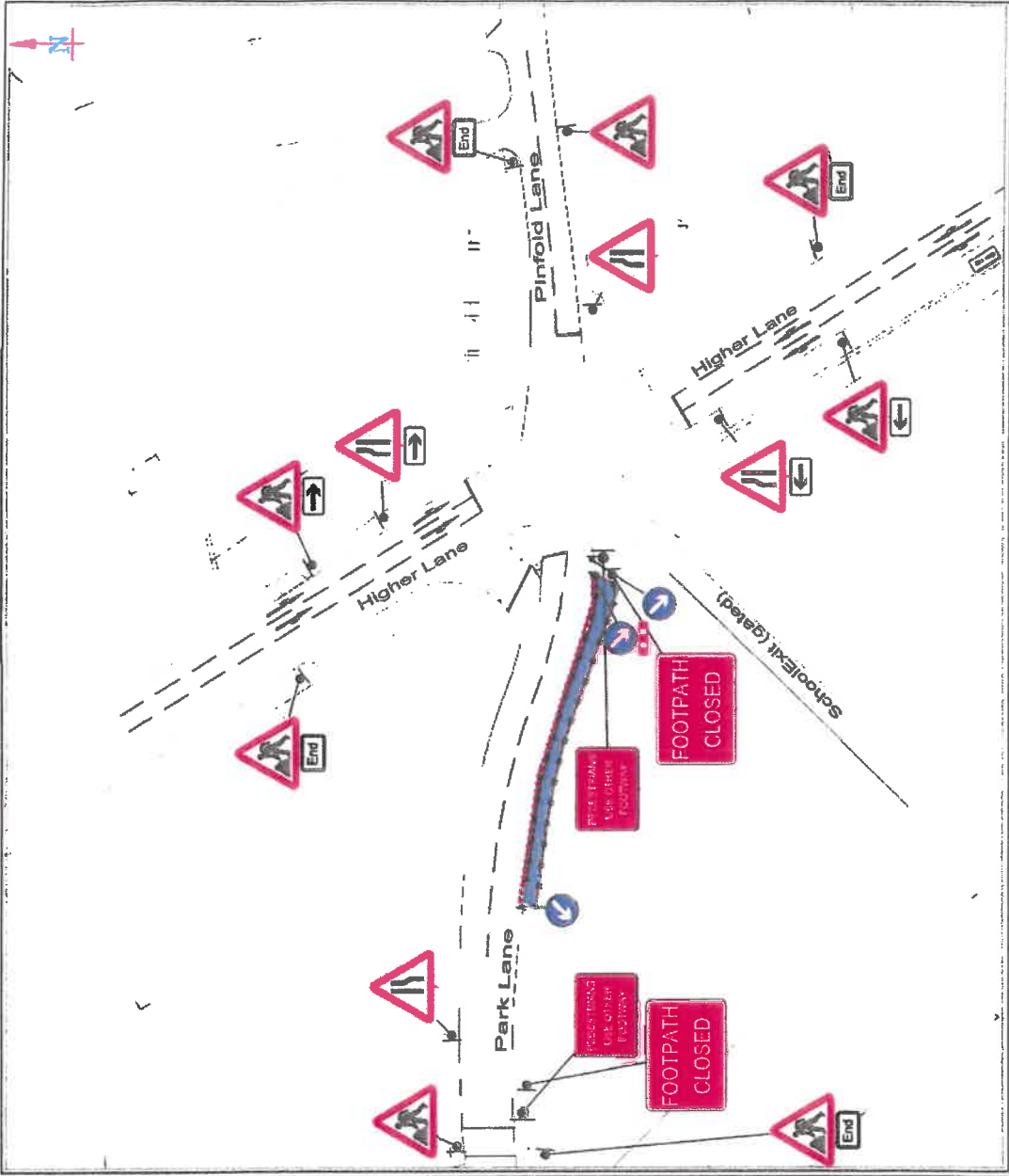

KEY

	Traffic sign
	Traffic cone
	Traffic signals to Diagram 3000.1
	Working Space
	Pedestrian Barrier

	SAFETY ZONE DIMENSIONS
	Permanent speed limit 30mph or less
	Sideways safety zone 0.5m
	Longways safety zone 0.5m
	(Dimensions are minima)

Park Lane, Higher Lane,
BURY.

Proposed Footpath
Closure.

COONEY
J. Cooney Ltd.
Alton Road, Rochdale, Lancs. OL11 4HQ
Tel: (01706) 641484 Fax: (01706) 647861
www.cooney.co.uk

LANTRA
AWARDS
APPROVED

JC/635/3

Original drawing size A3 - NTS

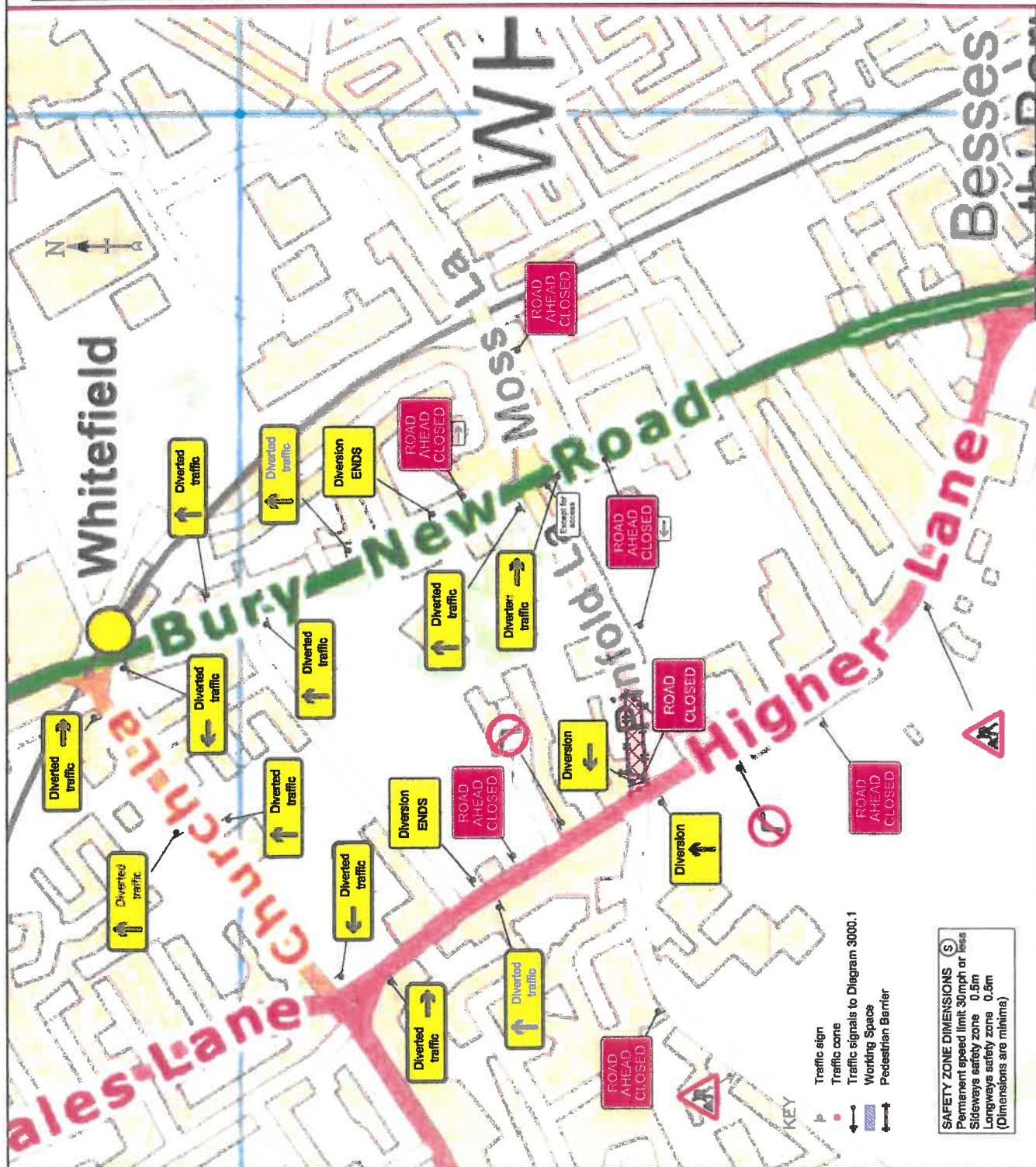

QTY: 2 REF: 7001 Road works ahead	
QTY: 7 REF: 7010-1 Nature of temporary hazard ahead - Road Ahead Closed	
QTY: 2 REF: 7010-1 Nature of temporary hazard ahead - Road Closed	
QTY: 1 REF: 2702 Start of temporary diversion route (ahead)	
QTY: 1 REF: 2702 Start of temporary diversion route (left)	
QTY: 1 REF: 612 No right turn	
QTY: 1 REF: 613 No left turn	
QTY: 7 REF: 2703 Direction of temporary diversion route from junction ahead (ahead)	
QTY: 2 REF: 2702 End of temporary diversion route (text)	
QTY: 3 REF: 2703 Direction of temporary diversion route from junction ahead (right)	
QTY: 2 REF: 673 Direction to hazard	
QTY: 2 REF: 2703 Direction of temporary diversion route from junction ahead (left)	
QTY: 1 REF: 620 Except for access	

Higher Lane / Pinfold Lane

BURY.

Proposed Diversion plan

Road closure / Diversion.

CB.

07.06.19

Date

COONEY

Civil Engineering Contractors

J. Cooney Ltd.
John Road, Baddiley, Lancs. OL11 4PL Tel: (01706) 641494 Fax: (01706) 672891

Drawing No

JC/636/1

LANTRAY AWARDS

APPROVED

inal drawing size A3 - NTS

SAFETY ZONE DIMENSIONS
Permanent speed limit 30mph or less
Sideways safety zone 0.5m
Longways safety zone 0.5m
(Dimensions are minima)